

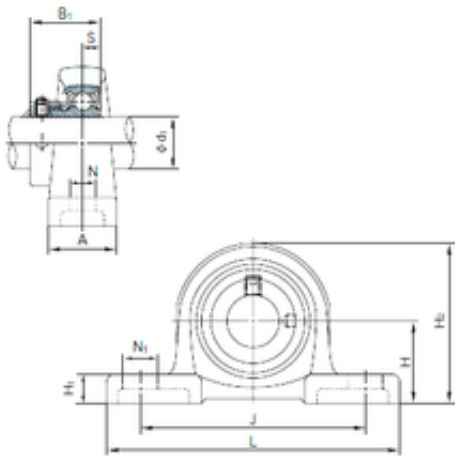

NACHI KHLLP202AJ bearing units



Bearing No. KHLLP202AJ

Bore Diameter	15 mm
Width	28.6 mm
d	15 mm
A	25 mm
B	28.6 mm
H	30.2 mm
H1	12 mm
H2	57 mm
J	87 mm
L	114 mm
N	12 mm
N1	16 mm
S	6.5 mm
Bolt (G)	M10

KHLLP202AJ Bearing 2D drawings and 3D CAD models