

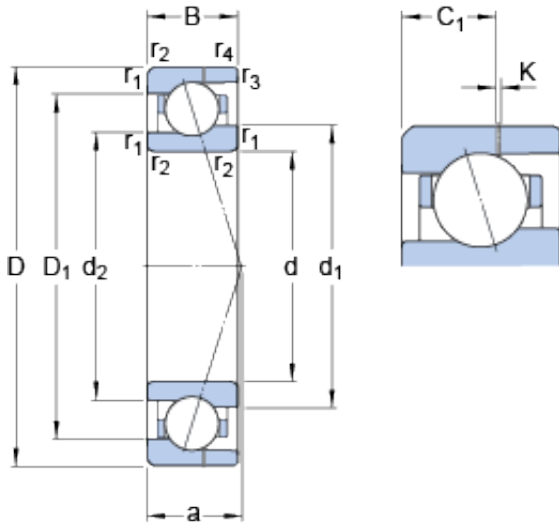

NTN BEARING-SUDAMERICANA, S.A.



12 mm x 24 mm x 6 mm SKF 71901 CE/HCP4AH angular contact ball bearings

Bearing No. 71901 CE/HCP4AH

71901 CE/HCP4AH Bearing 2D drawings and 3D CAD models

Size	24x12x6 mm
Bore Diameter	24 mm
Outer Diameter	12 mm
Width	6 mm
d	12 mm
D	24 mm
B	6 mm
d ₁	16 mm
d ₂	15.26 mm
D ₁	19.95 mm
K	0.5 mm
C ₁	3.65 mm
r _{1,2} - min.	0.3 mm
r _{3,4} - min.	0.15 mm
a	5.7 mm
d _a - min.	14 mm
d _b - min.	14 mm
D _a - max.	22 mm
D _b - max.	23.2 mm
r _a - max.	0.3 mm
r _b - max.	0.15 mm
d _n	16.8 mm
Basic dynamic load rating - C	2.1 kN
Basic static load rating - C ₀	0.915 kN



NTN BEARING-SUDAMERICANA, S.A.

Fatigue load limit - P_u	0.039 kN
Limiting speed for grease lubrication	109000 r/min
Limiting speed for oil lubrication	165000 mm/min
Ball - D_w	3.175 mm
Ball - z	12
G_{ref}	0.1 cm ³
Calculation factor - f_0	7.8
Preload class A - G_A	11 N
Preload class B - G_B	34 N
Preload class C - G_C	68 N
Calculation factor - f	1.04
Calculation factor - f	1
Calculation factor - f_{2A}	1
Calculation factor - f_{2B}	1.05
Calculation factor - f_{2C}	1.09
Calculation factor - f_{HC}	1.01
Preload class A	12 N/micron
Preload class B	19 N/micron
Preload class C	26 N/micron
d_1	16 mm
d_2	15.26 mm
D_1	19.95 mm
C_1	3.65 mm
$r_{1,2}$ min.	0.3 mm
$r_{3,4}$ min.	0.15 mm
d_a min.	14 mm
d_b min.	14 mm
D_a max.	22 mm
D_b max.	23.2 mm



NTN BEARING-SUDAMERICANA, S.A.

r_a max.	0.3 mm
r_b max.	0.15 mm
d_n	16.8 mm
Basic dynamic load rating C	2.12 kN
Basic static load rating C_0	0.915 kN
Fatigue load limit P_u	0.039 kN
Attainable speed for grease lubrication	109000 r/min
Attainable speed for oil-air lubrication	165000 r/min
Ball diameter D_w	3.175 mm
Number of balls z	12
Reference grease quantity G_{ref}	0.1 cm ³
Preload class A G_A	11 N
Static axial stiffness, preload class A	12 N/ μ m
Preload class B G_B	34 N
Static axial stiffness, preload class B	19 N/ μ m
Preload class C G_C	68 N
Static axial stiffness, preload class C	26 N/ μ m
Calculation factor f	1.04
Calculation factor f_1	1
Calculation factor f_{2A}	1
Calculation factor f_{2B}	1.05
Calculation factor f_{2C}	1.09
Calculation factor f_{HC}	1.01
Calculation factor f_0	7.8
Mass bearing	0.009 kg