

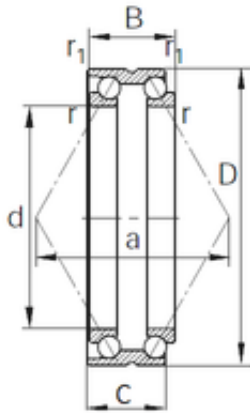

NTN BEARING-SUDAMERICANA, S.A.

165 mm x 210 mm x 52 mm KBC SDA0102
angular contact ball bearings



Bearing No. SDA0102

| | |
|-------------------------------|---------------|
| Size | 165x210x52 mm |
| Bore Diameter | 165 mm |
| Outer Diameter | 210 mm |
| Width | 52 mm |
| d | 165 mm |
| D | 210 mm |
| B | 52 mm |
| C | 47.5 mm |
| Angle (°) | 30 ° |
| a | 82.5 mm |
| r min. | 1.1 mm |
| r1 min. | 1.1 mm |
| Basic dynamic load rating (C) | 118 kN |

SDA0102 Bearing 2D drawings and 3D CAD models