

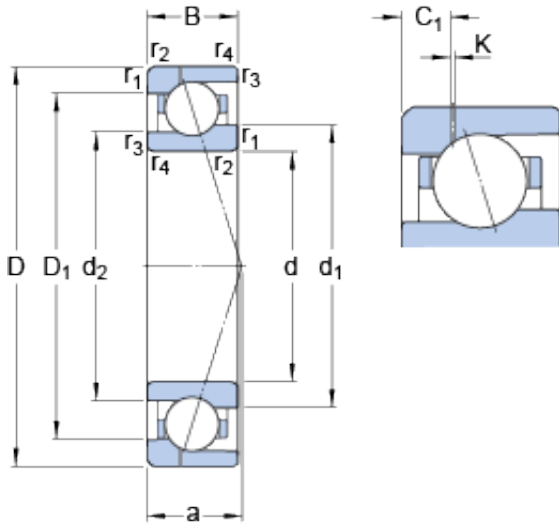

NTN BEARING-SUDAMERICANA, S.A.



60 mm x 85 mm x 13 mm SKF 71912
CE/P4AH1 angular contact ball bearings

Bearing No. 71912 CE/P4AH1

71912 CE/P4AH1 Bearing 2D drawings and 3D CAD models

Size	85x60x13 mm
Bore Diameter	85 mm
Outer Diameter	60 mm
Width	13 mm
d	60 mm
D	85 mm
B	13 mm
d ₁	67.75 mm
d ₂	65.7 mm
D ₁	77.3 mm
K	0.5 mm
C ₁	3.83 mm
r _{1,2} - min.	1 mm
r _{3,4} - min.	0.3 mm
a	16.8 mm
d _a - min.	64.6 mm
d _b - min.	62 mm
D _a - max.	80.4 mm
D _b - max.	83 mm
r _a - max.	1 mm
r _b - max.	0.3 mm
d _n	69.6 mm
Basic dynamic load rating - C	16.3 kN
Basic static load rating - C ₀	11.8 kN



NTN BEARING-SUDAMERICANA, S.A.

Fatigue load limit - P_u	0.5 kN
Limiting speed for grease lubrication	22000 r/min
Limiting speed for oil lubrication	34000 mm/min
Ball - D_w	7.938 mm
Ball - z	23
G_{ref}	2.5 cm ³
Calculation factor - f_0	8.5
Preload class A - G_A	87 N
Preload class B - G_B	262 N
Preload class C - G_C	523 N
Calculation factor - f	1.13
Calculation factor - f	1
Calculation factor - f_{2A}	1
Calculation factor - f_{2B}	1.04
Calculation factor - f_{2C}	1.08
Calculation factor - f_{HC}	1
Preload class A	47 N/micron
Preload class B	73 N/micron
Preload class C	100 N/micron
d_1	67.75 mm
d_2	65.7 mm
D_1	77.3 mm
C_1	3.83 mm
$r_{1,2}$ min.	1 mm
$r_{3,4}$ min.	0.3 mm
d_a min.	64.6 mm
d_b min.	62 mm
D_a max.	80.4 mm
D_b max.	83 mm



NTN BEARING-SUDAMERICANA, S.A.

r_a max.	1 mm
r_b max.	0.3 mm
d_n	69.6 mm
Basic dynamic load rating C	16.3 kN
Basic static load rating C_0	11.8 kN
Fatigue load limit P_u	0.5 kN
Attainable speed for grease lubrication	22000 r/min
Attainable speed for oil-air lubrication	34000 r/min
Ball diameter D_w	7.938 mm
Number of balls z	23
Reference grease quantity G_{ref}	2.5 cm ³
Preload class A G_A	87 N
Static axial stiffness, preload class A	47 N/ μ m
Preload class B G_B	262 N
Static axial stiffness, preload class B	73 N/ μ m
Preload class C G_C	523 N
Static axial stiffness, preload class C	100 N/ μ m
Calculation factor f	1.13
Calculation factor f_1	1
Calculation factor f_{2A}	1
Calculation factor f_{2B}	1.04
Calculation factor f_{2C}	1.08
Calculation factor f_{HC}	1
Calculation factor f_0	8.5
Mass bearing	0.19 kg